

Revision Notes

R1 - TABLE UPDATED	Drawn: M BUTLER	Checked: M BUTLER	Approved: D KERAI	Date: 02/11/10
APPA: -	Drawn: -	Checked: M BUTLER	Approved: S MATTHEWS	Date: 23/09/11
R2 - CONNECTOR PIN OUT UPDATED TO NEW STANDARD.	Drawn: -	Checked: M BUTLER	Approved: S MATTHEWS	Date: 23/09/11
APPA: -	Drawn: -	Checked: M BUTLER	Approved: S MATTHEWS	Date: 23/09/11
R3 - VIEW A MATING FACE AND PINOUT DETAILS UPDATED AS PER ECR CR-A204.	Drawn: -	Checked: M BUTLER	Approved: S MATTHEWS	Date: 23/09/11
APPA: T CH01	Drawn: R BATES	Checked: A FEDRIGHI	Approved: G PLUTH	Date: 02/04/14

ITEM	PART NO	QTY	MODEL/DESCRIPTION
①	(#3243B)	1	BE-800C-C CAMERA ONLY
②	(#3244)	1	BE-89XC/BE-X0XC-BKT CAMERA BRACKET
③	(#3245)	1	BE-89XC/BE-X0XC-SS CAMERA SUNSHIELD
④	(#3246)	1	BE-2XXC/8XXC-FIX CAMERA FIXING PACK
⑤	(#3247)	1	BE-89XC/BE-X0XC-IG INSTALLATION GUIDE (NOT SHOWN)
⑥	(#3521)	1	BE-8XXC PB BOX (NOT SHOWN)

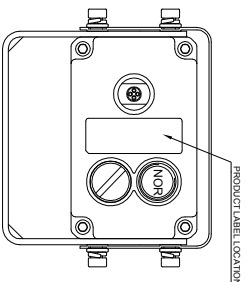
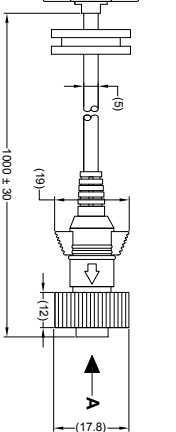
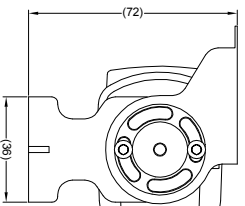
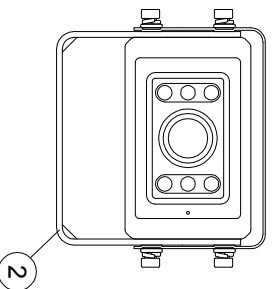
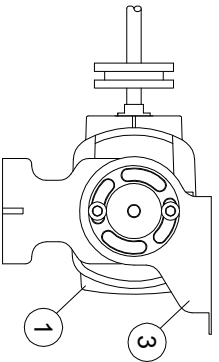
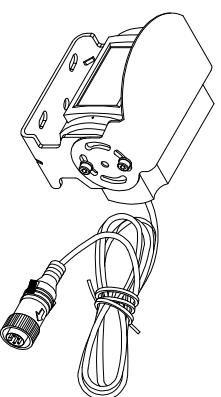
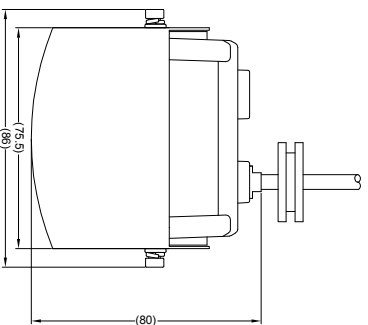

VIEW A

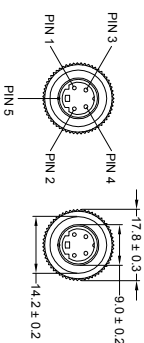

4 PIN MINI DIN MALE MATING FACE

PIN #	WIRE COLOUR	DESCRIPTION
1	YELLOW	VIDEO
2	RED	+12V
3	BLUE	N/C
4	WHITE	AUDIO
5	BLACK/SHIELD	GND

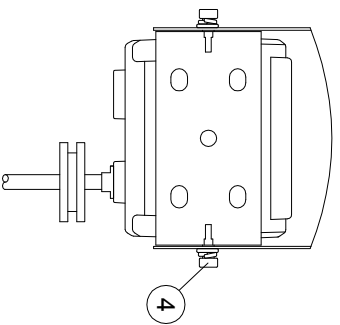

- NOTES:**
1. REFER TO "PRODUCT SPECIFICATION" FOR MORE DETAILS.
 2. REFER TO COMPONENT DRAWINGS FOR COMPONENT DETAILS.
 3. ENSURE SELF-AMALGAMATING TAPE IS USED DURING INSTALLATION.
 4. ANY CUSTOMER MODIFICATION OF THIS PRODUCT CAUSING SUBSEQUENT FAILURE IS NOT A LIABILITY OF BRIGADE ELECTRONICS PLC.

PROPRIETARY NOTICE

THIS DESIGN AND TECHNICAL INFORMATION APPEARING ON THIS DRAWING IS THE PROPERTY OF BRIGADE ELECTRONICS, AND IS DISCLOSED IN CONFIDENCE. IT IS NOT TO BE COPIED, REPRODUCED, REVEALED TO OR EXPLOITED BY OTHERS, EITHER IN WHOLE OR IN PART WITHOUT THE EXPRESS WRITTEN CONSENT OF BRIGADE ELECTRONICS.

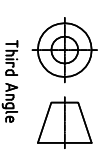

Assembly PI Approval		Approved by		Checked by		Drawn by	
-		DKERALI		JNEWMAN		M BUTLER	
Units	Scale	Released	Assembly Ref				
mm	N/A	12/07/10	ECC-72H				
Status	DRAFT	BE-800C					
Part No	#1623B	BE-001103-03-10					